

Connect the tubes of the middle part

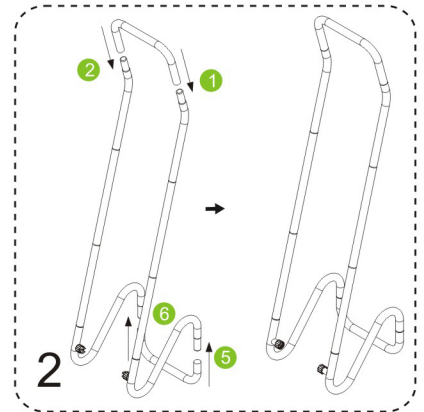

Then connect the tubes of the top part

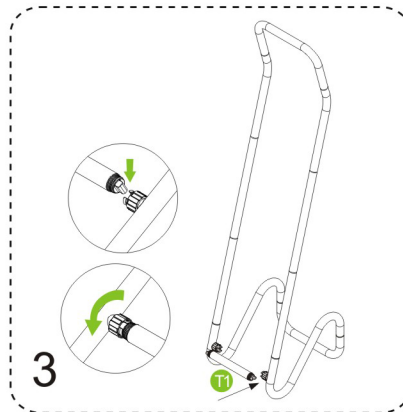

Connect the tubes of the bottom part

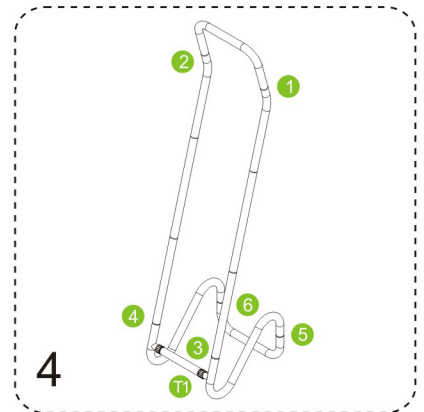

Finished



The plastic screwing connector at all corners section  
DON'T screw completely but around 90% fastening

## Graphic Setup Instruction

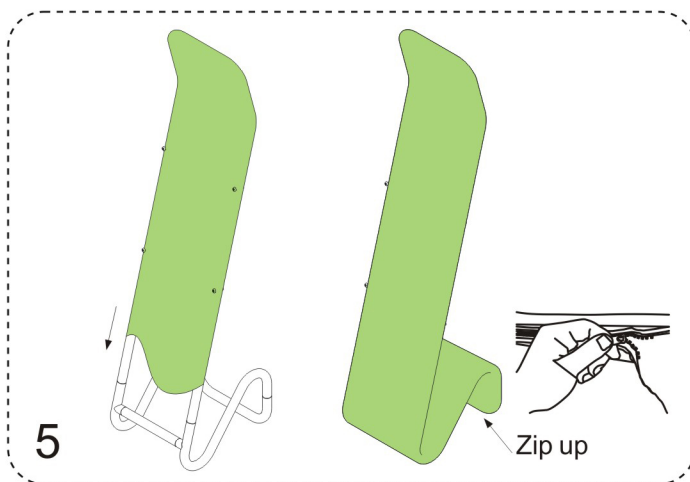

Wrap up the frame with the graphic from top to bottom then zip up

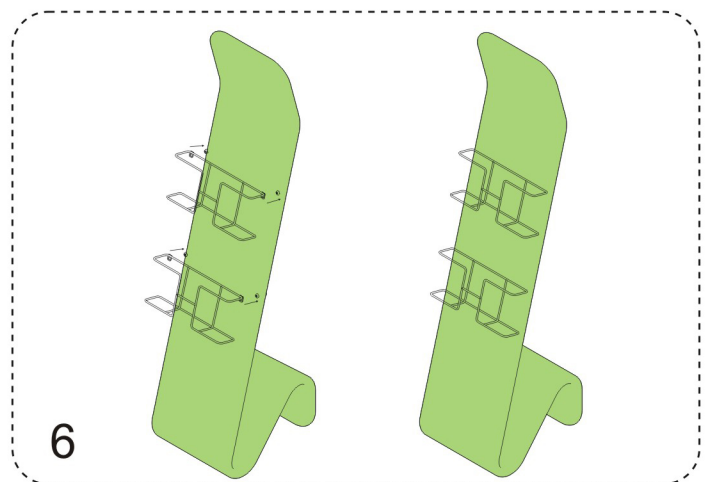

Put the catalogue shelves on the stand,  
use the hexagonal Key to fix the screw in place